

AK10K Carbon Brush Connection Check

1. Remove the back cover from generator set as pictured below.



2. Locate the carbon brushes



3. Make sure both connections are firmly connected by removing them both off the brushes. Make sure there is no debris on the contacts of brushes and connections to wires are good. Reconnect and try generator power output again.

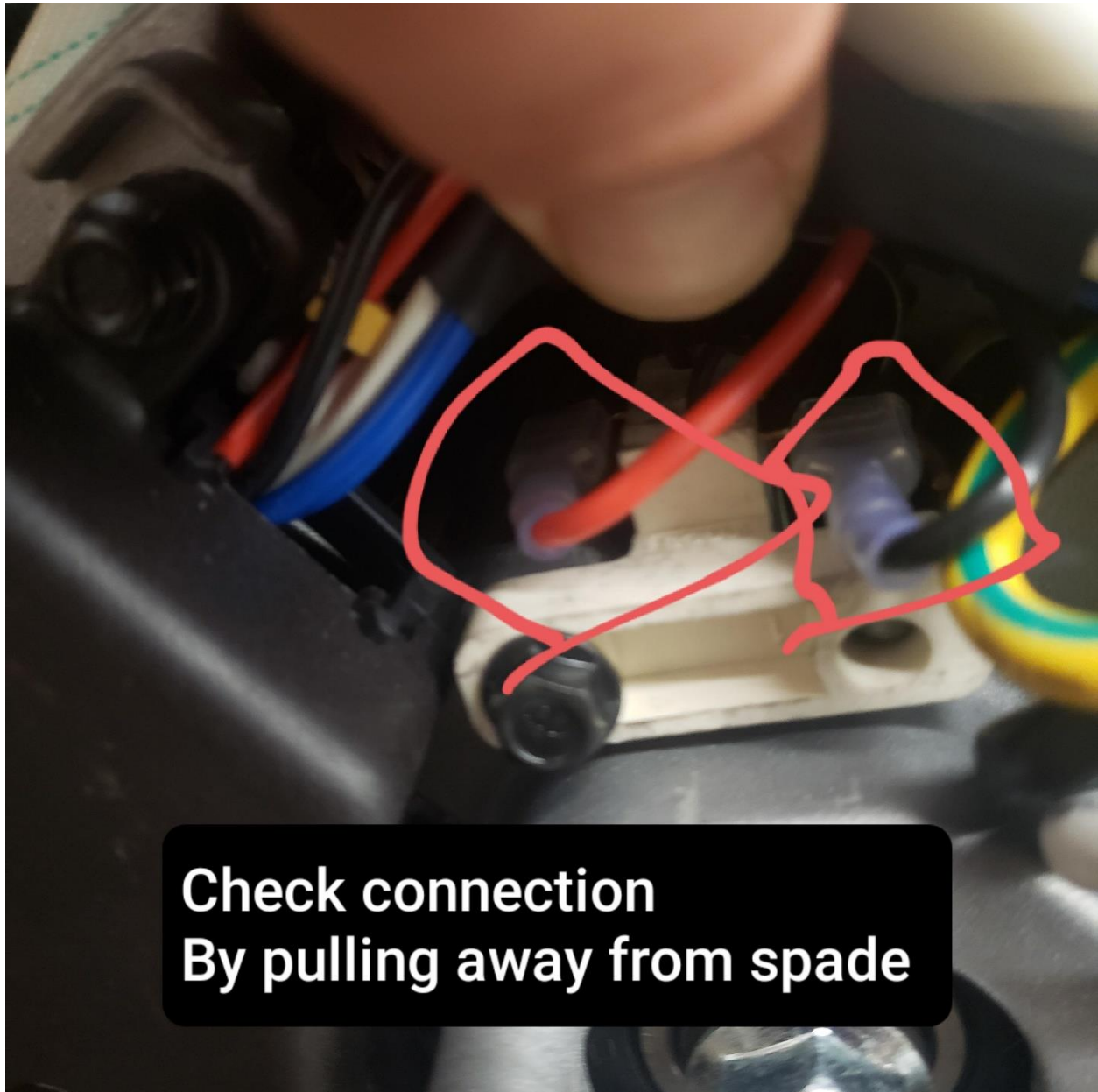

**Check connection
By pulling away from spade**

4. If that doesn't fix the issue, then disconnect the wires again. Remove the 8mm bolt holding the brushes in. Remove brushes and make sure they are retracting up and down. Secondly, make sure the brushes are relatively the same length and have no chips or worn grooves in them. They should be equal length and relatively flat. Your brushes are white, but minor imperfections on brushes are ok as you can see in picture below.

